

## Model OSBH Series Shear Beam Load Cell (200kg ~ 10t)

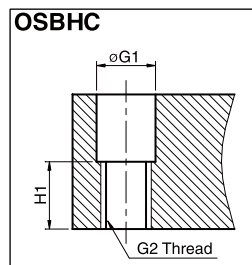

(1t~5t) (200kg~10t)

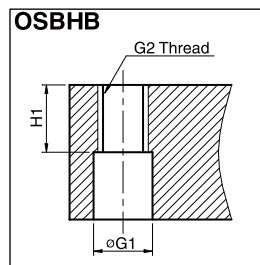
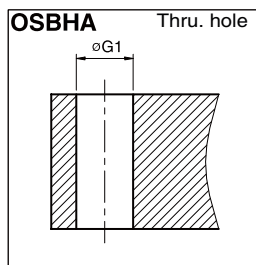
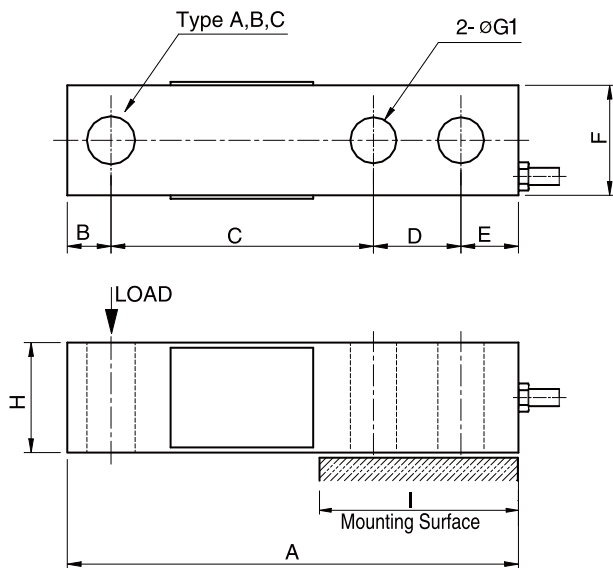

Dimension-mm(inch)

| Capacity                       | A      | B      | C      | D      | E      | F      | G1     | G2           | H      | H1     | I      | Weight |
|--------------------------------|--------|--------|--------|--------|--------|--------|--------|--------------|--------|--------|--------|--------|
| 200kg ~ 2t<br>(1.961~19.61kN)  | 131    | 12.7   | 76.2   | 25.4   | 16.7   | 32     | 13.5   | M12x1.75P    | 32     | 16     | 57     | 0.8    |
| 3, 5t<br>(29.42, 49.03kN)      | 171.5  | 19     | 95.3   | 38.1   | 19.1   | 38.1   | 20.5   | M20x2.5P     | 38     | 19     | 76.2   | 1.8    |
| 10t<br>(98.07kN)               | 222.3  | 25.4   | 120.7  | 50.8   | 25.4   | 50.8   | 26.2   | M24x2P       | 50.8   | 25     | 108    | 4.1    |
| 0.5k~4k lbs<br>(2.224~17.79kN) | (5.15) | (0.50) | (3.00) | (1.00) | (0.65) | (1.25) | (0.53) | 1/2" -20 UNF | (1.25) | (0.62) | (2.24) | (1.7)  |
| 5k, 10k lbs<br>(22.24~44.48kN) | (6.75) | (0.75) | (3.75) | (1.50) | (0.75) | (1.50) | (0.78) | 3/4" -16 UNF | (1.50) | (0.74) | (3.0)  | (4.0)  |
| 20k lbs<br>(88.97kN)           | (8.75) | (1.00) | (4.75) | (2.00) | (1.00) | (2.00) | (1.02) | 1" -14 UNF   | (2.00) | (0.98) | (4.25) | (9.0)  |

The OSBH series single ended shear beam load cell is designed for high accuracy platform scales and a variety of process weighing applications.

- Alloy tool steel construction for high accuracy.
- Electroless nickel plated for corrosion resistance.
- Fully sealed to IP67.

### SPECIFICATIONS

| MODEL                         | OSBHA, OSBHB, OSBHC   |
|-------------------------------|---|
| Rated capacity (R.C.)         | 200, 500kg, 1, 2, 3, 5, 10 t<br>0.5, 1, 2, 4, 5, 10, 20klb  |
| Rated output(R.O.)            | 3.0mV/V $\pm$ 0.25%   |
| Non-linearity                 | $\leq$ 0.03% R.O.   |
| Hysteresis                    | $\leq$ 0.02% R.O.   |
| Non-repeatability             | $\leq$ 0.02% R.O.   |
| Creep error                   | $\leq$ 0.03% in 20min.  |
| Zero balance                  | $\leq$ 1% R.O.  |
| Compensated temperature range | -10 ~ 70°C  |
| Operating temperature range   | -20 ~ 80°C  |
| Temp. effect on rated output  | $\leq$ 0.02% LOAD/10°C  |
| Temp. effect on zero balance  | $\leq$ 0.02% R.O./10°C  |
| Terminal input resistance     | 400 Ohms $\pm$ 20 Ohms  |
| Terminal output resistance    | 350 Ohms $\pm$ 5 Ohms   |
| Insulation resistance (Min.)  | 2000 MOhms at 50V DC  |
| Excitation voltage            | 10V(Recommended), 15V(Max.)   |
| Electrical connection         | 200kg ~ 2t $\phi$ 5mmx3m(Standard), 6m(Option)<br>(22AWG x 4Core Shielded) 3, 5t(10t) $\phi$ 5mmx6m( $\phi$ 7mmx6m) |
| Protection class              | meets IP 67   |
| Safe overload                 | 150% R.C  |
| Ultimate overload             | 300% R.C  |

### ORDERING INFORMATION

#### OSBHA - 2T

| MODEL | CAPACITY                     |
|-------|------------------------------|
| OSBHA | 200, 500kg, 1, 2, 3, 5, 10 t |
| OSBHB | 0.5, 1, 2, 4, 5, 10, 20 klbs |
| OSBHC |                              |

### WIRING INFORMATION

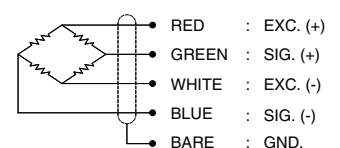

\* Specifications are subject to change without notice

JUL, 2016